

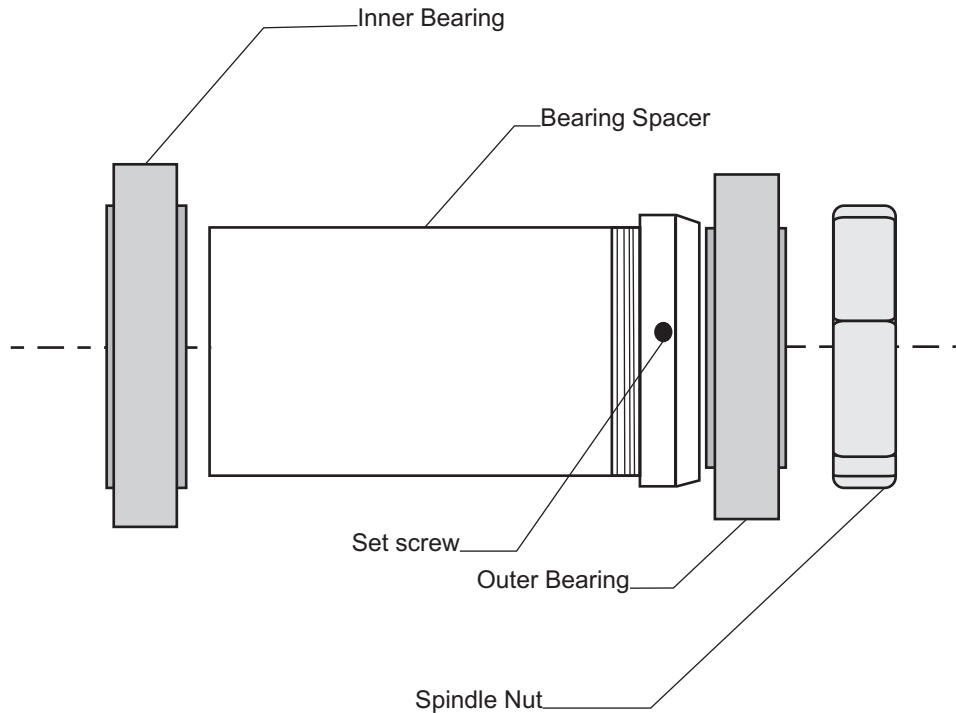

Part No. PPM3857

Bearing Spacer Installation Instructions



**** Initial setup is easier and cleaner to do with new ungreased bearings.**

- 1) Install Wide 5 Hub with inner bearing on snout or spindle.
- 2) Loosen set screws on bearing spacer and adjust nut to center of threads (do not tighten set screws at this point).
- 3) Install spacer on snout with adjustment nut facing out.
- 4) Install outer bearing and spindle nut. If the spindle nut tightens and your hub is loose, then the bearing spacer is too long. If the spindle nut tightens and your hub is tight and won't spin freely then the bearing spacer is too short.
- 5) Remove the spindle nut, outer bearing and bearing spacer.
- 6) Adjust bearing spacer adjustment nut according to your hub condition in step 4. Turn adjustment nut clockwise to shorten spacer or counterclockwise to lengthen. (Helpful Hint – mark a line on the spacer and the nut to reference your adjustments.)
- 7) Repeat steps 3 and 4 (several times if necessary) until the spindle nut is tight and your hub still spins freely.
- 8) Now that your clearance is set, carefully remove all components, tighten set screws, grease your bearings and re-install your assembly. We recommend marking each spacer with each specific hub as every setting is different.

**** It is highly recommended to re-check these settings after initial on track use.**

Bearing spacer Length for Wilwood hubs is 3.575".

(This is just a starting point and may vary)

TECHNICAL QUESTIONS CALL 1-865-354-9669